

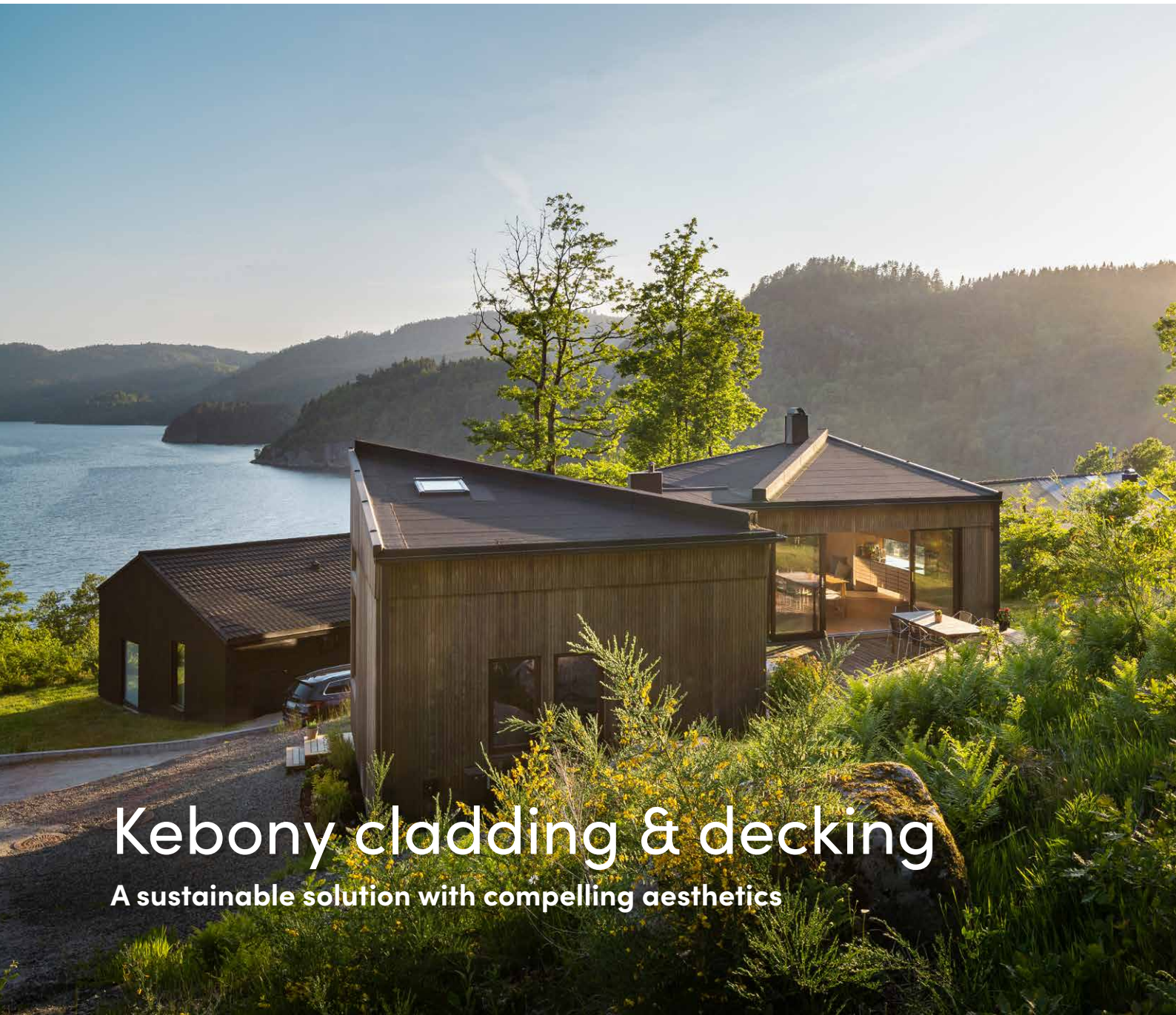

Natural wood
Made to last



Kebony cladding & decking

A sustainable solution with compelling aesthetics



Valley Villa, Lithuania, by Archés architects

Helping the world to reduce CO₂

Kebony is a Norwegian company with production sites in both Norway and Belgium, globally providing the most sustainable and long-lasting alternative to hardwood. This enhanced wood of superior quality helps to reduce the world's CO₂ emissions, revolutionises the construction industry and builds a better future.



A sustainable alternative, globally underpinned

The purpose of Kebony is perfectly encapsulated in the global ambition to deal with deforestation by offering a sustainable alternative. We can use renewable substitutions for hardwood to save pristine forests. On top of that, we can save up to 40% of global carbon emissions by building with timber.

Superior sustainable wood

The construction industry is one of the world's most heavily polluting industries. There is an urgent need for faster, better and greener alternatives to traditional construction materials, including steel and concrete, to help combat climate change.

That is why building projects need to be rethought. Because in addition to mechanical strength, safety in use and durability, environmental compatibility criteria are becoming increasingly important when it comes to building materials.



Kebony is high-quality wood from sustainably managed FSC® certified pine forests, Dually Modified™ with the patented Kebony technology to reach the hardness level of the best tropical hardwoods. It combines the best of both worlds, by harnessing the most sustainable solutions without compromising on aesthetics.

With the sustainability report, Kebony reaffirms its commitment to producing attractive, durable and environmentally friendly products.



Find more information in our sustainability report.



SkiStar Lodge Hemsedal Suites, Norway, by HR Projekt, Gol



Farsta Lakefront, Norway, by Karavan Landscape architect



Waldorf school, Norway, by LinkArkitekter



Camber Sands, England, by WAMdesign

Sustainability is in our DNA

The need for a sustainable alternative to tropical hardwood is more pressing than ever. An increasing number of common hardwoods are being safeguarded against deforestation. In 2022, five common hardwoods were formally listed in CITES (Convention on International Trade in Endangered Species of Wild Fauna and Flora) Appendix II, impacting the global offer of these precious woods.

This paves the way for a sustainable alternative like Kebony, which in turn paves the way for a sustainable future in the construction industry. Kebony bridges the gap between humans and nature through the use of organic materials.

Kebony was the first product to achieve the Nordic Swan eco-label for wood products. This certification sets strict environmental requirements for chemicals in products labelled as eco and applies to all relevant phases of a product's life cycle.



Why design with Kebony?

- **Sustainable solution**
- **Natural wood**
- **Dually Modified™ wood**
- **Highly durable, weather resistant and easy maintenance**
- **Ideal for outdoor cladding and decking**
- **Quality comparable or superior to tropical hardwoods**
- **Up to 35 years warranty without treatment**



Dually Modified™ wood

Kebony employs a patented technique to enhance the wood's strength and longevity significantly.

To obtain this, Kebony is using a biobased liquid to modify the wood. Two major actions are happening simultaneously in the wood cell:

1. Active modification: the biobased liquid reacts with OH-groups present in wood and reduces the water sensitivity significantly. This reaction increases the durability of the wood.
2. Passive modification: the biobased liquid forms a polymer that is reinforcing the wood which contributes directly to the strength and hardness of the wood and gives the brown colour.

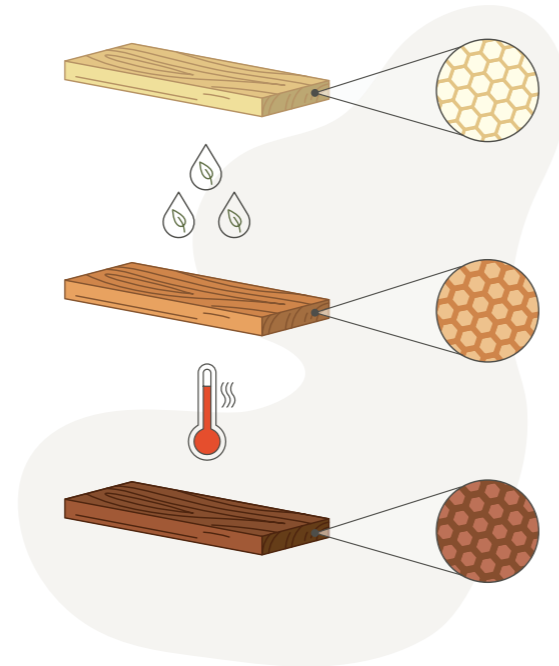

Thanks to this unique dually modified™ process Kebony is able to replicate nature and produce wood with equal or superior performance of tropical hardwood, in a fast and sustainable way.



Expert insight

Wood as a construction material is active climate protection: wood products are CO₂ stores. They store carbon extracted from the atmosphere by the original tree from which they were made (1 tonne per cubic metre of wood). This means that the carbon remains stored and is not released into the atmosphere. Thanks to its long-lasting quality, Kebony wood is often recycled to extend its life cycle.

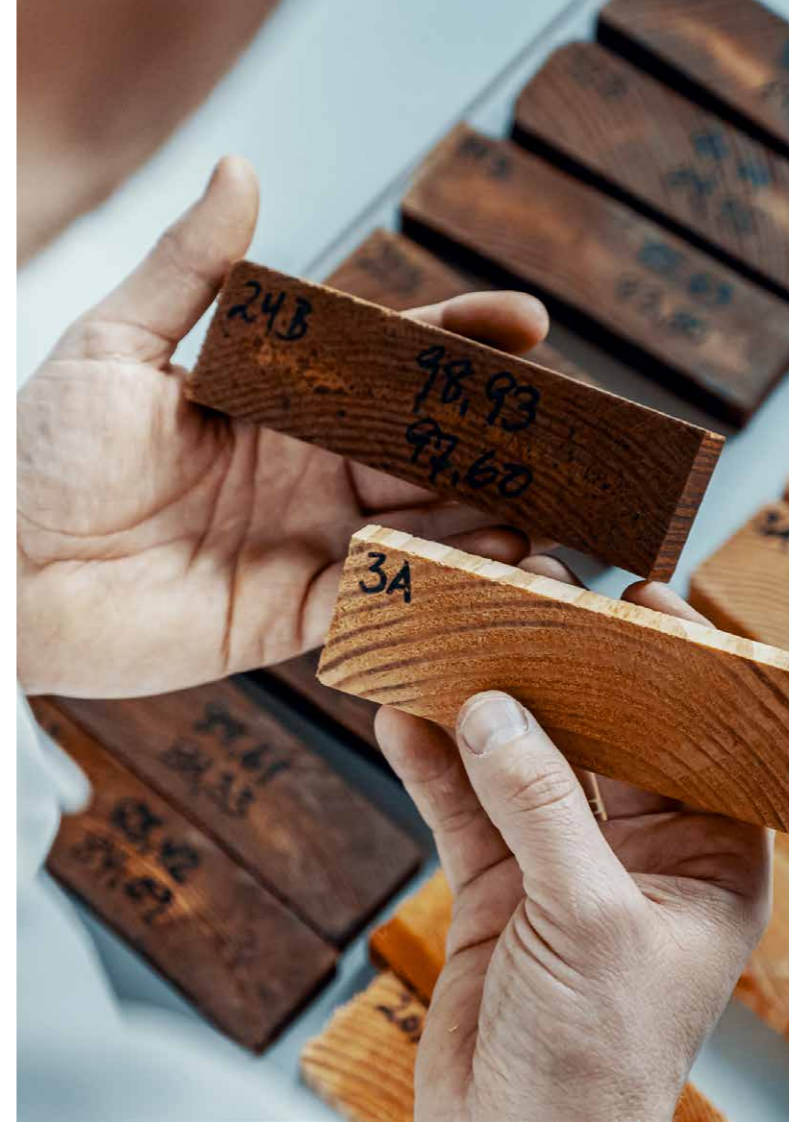

One technology, two finishes

Different projects call for different solutions. Kebony offers two finishes that each tailor to a distinctive look.

Kebony Clear

Pure design delight

Kebony Clear wood is perfectly suitable for residential and commercial properties. The discreet grain creates a harmonious overall appearance. Kebony Clear is made from FSC® certified Pinus radiata. The wood is fully impregnated, making it as durable and strong as any hardwood.

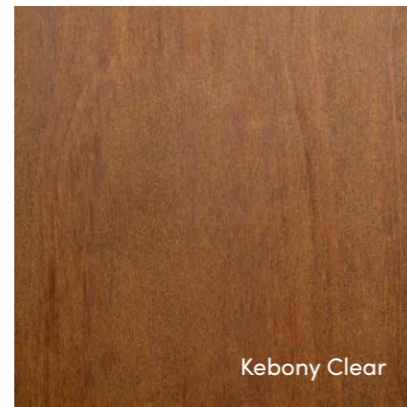

Kebony Character

Rustic charm

Kebony Character delivers wooden boards with a rustic flair. Character is made from FSC® certified Pinus sylvestris. The boards can be cut to length, the ends should be sealed.



Highly durable, weather resistant and easy maintenance

Excellent durability class

Kebony wood is regarded as durability class 1, the most durable category of the European Standard EN350.

WOOD SPECIES	DURABILITY <small>1 = very durable EN 350</small>	BRINELL HARDNESS <small>Brinell N/mm² EN 1534</small>	SWELLING BEHAVIOUR <small>Dry to wet in tangential direction (%)</small>
Kebony Clear	1	41	4
Ipé	1	53	6
Teak	1	34	3-4
Thermo ash	1-2	30	5
Kebony Character	1-2*	20-30	5
Bangkirai	2	63	11
Oak	2	33	4-6
Thermo pine	2	16	4
Siberian larch	2-3	17	7
Nordic pine	3-4	17	8

Easy maintenance

All woods by Kebony need limited to no maintenance. Removing deposits of dirt, sand and other particles is simply done with a brush and water. Beyond normal cleaning, Kebony wood does not require any special maintenance.

Dimensionally stable

Kebony is natural wood, which means there will be some swelling and shrinkage due to changes in humidity. However, our modification process dramatically increases the dimensional stability of the wood.

Lifetime cost

The lower the maintenance, the lower the cost. As the maintenance needs for Kebony wood are next to none, its lifetime cost is far lower than other solutions on the market.

Wood made to last... for generations to come

Kebony wood is immediately ready for use, without any treatment. And as a result of Kebony's high durability ratings, there is a warranty of up to 35 years against rot (for all Kebony products in above-ground usage).



PRODUCT CATEGORY	DURABILITY EN 350	USE CLASS EN 1534	WARRANTY AGAINST ROT** from purchase date
Kebony Character			
Decking boards	1-2*	3,2	20 years
Cladding profile	1-2*	3,1	30 years
Kebony Clear			
Decking boards	1	3,2	30 years
Cladding profile	1	3,1	35 years
Structural timber	1	3,2	30 years
Standard rough-sawn products	1	3,2	30 years

* Treated sapwood

** You will find the product-related warranty promise at www.kebonny.com





Cardis Bay Hotel, United Kingdom, by The Bazeley Partnership

Ideal for outdoor cladding and decking

Thanks to its excellent durability, Kebony can be used outdoors in applications which include decking, cladding, flooring, roofing, as well as public space design and outdoor furniture.

Cladding

Kebony is leading the way in sustainable and long-lasting real wood cladding. Our award-winning cladding projects have solidified Kebony as the go-to for top architects. Kebony cladding is unmatched in beauty, durability, and sustainability.

Decking

Our Kebony Clear decking is engineered to handle the harshest of conditions. The rich brown colour and clear grain are designed to impress, while hardwood-like durability and a rot and decay warranty provide supreme peace of mind. Whether you maintain the original colour or let Kebony naturally develop a silver patina, your projects will amaze for decades to come.

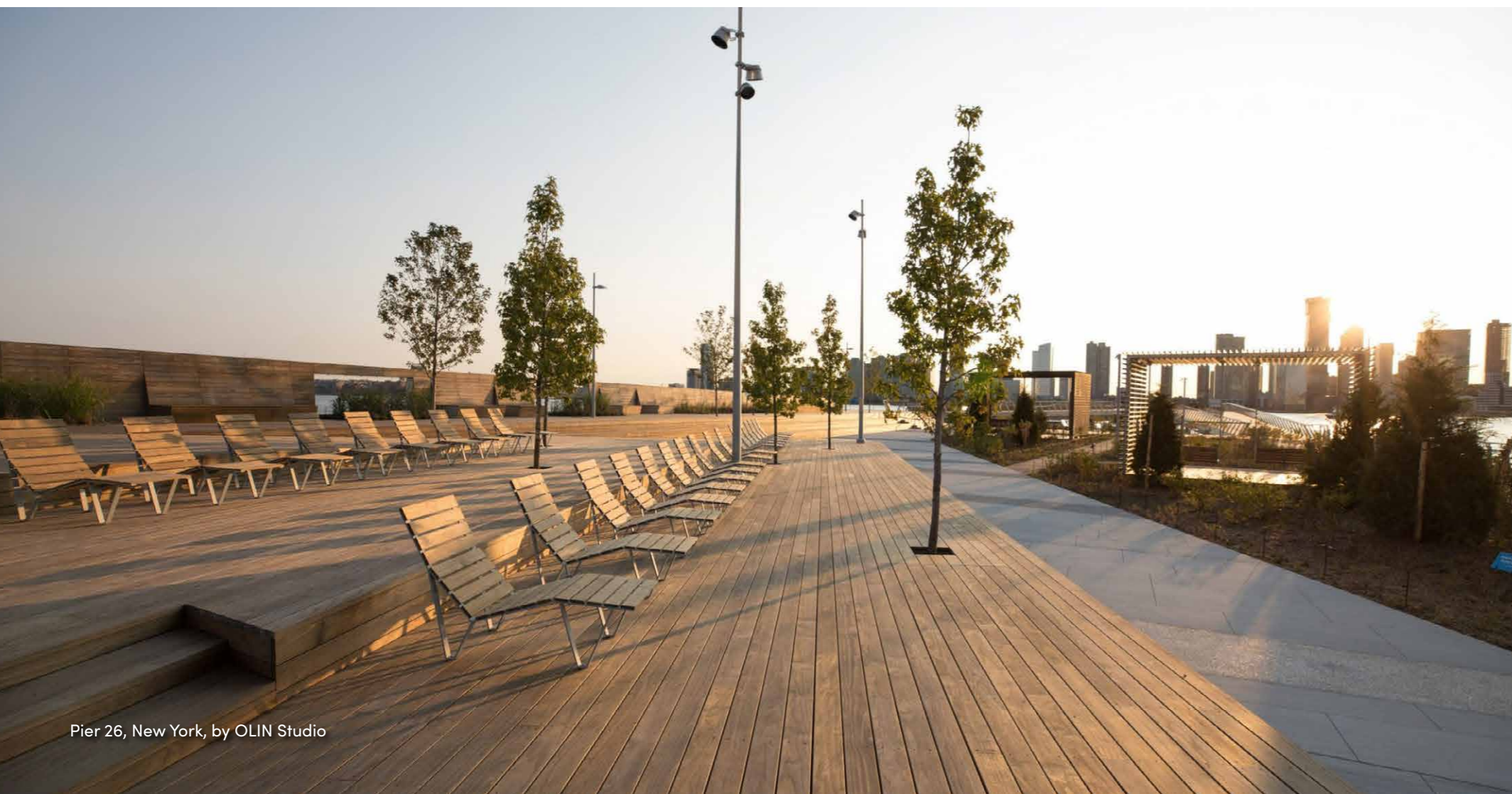

Pier 26, New York, by OLIN Studio

Natural wood weathering

Kebony's patented technology modifies softwood with an organic liquid to thicken the wood cells. The resulting polymer is permanently bonded inside the wood fibres, creating a stable, hard, and durable wood.

Comparison: newly built and after 3 years

The Kebony technology gives the wood its dark brown colour. Nevertheless, Kebony is natural wood. As is the case with hardwood, exposure to weather conditions like rain and sunlight transform the brown colour into a unique silver-grey patina. You could simply let the wood naturally grey like any hardwood. However, if it better suits your project, the brown colour can be preserved with UV-protective oils.

The colour shades and their progression can vary. Colour changes and surface cracks resulting from the natural weathering process emphasise the naturalness of the material. These have no effect on the durability and general properties of the wood.

Expert insight on samples

For professionals, we recommend using a sample surface instead of swatches, as a panel clearly shows the longer-term quality. Such samples are available via our distributors or via www.kebony.com



Quality superior to other solutions

Kebony's modification process improves the wood, which makes it superior to hardwood. Also, in comparison with other solutions on the market, Kebony's modified wood outperforms.

	KEBONY	VS. TROPICAL HARDWOOD
Durability	Very resistant to warping, cupping and splintering.	Extremely hard to work with , because it's more than twice as hard as Kebony. Processing it also generates more waste.
Appearance	Very uniform colour and grain pattern	Variations in colour and grain
Maintenance	Little to no maintenance for patina to a silver/grey. To keep the lustrous brown colour, use a UV inhibiting Hardwood oil.	Little to no maintenance for patina to a silver/grey. Hardwood oil does not soak in due to density. Ensure to wipe back excess oil.
Environmental impact	Sustainably harvested from FSC® certified forests , eco-friendly chemicals.	Often retrieved through unsustainable logging leading to deforestation of rainforests. Protected by CITES Appendix II.

	KEBONY	VS. THERMALLY MODIFIED
Modification process	Non-toxic bio-based liquid derived from agricultural plant waste to thicken wood cells.	Thermal treatment process to thin wood cells, which increases brittleness .
Durability	Resistance to microbial decay, increased dimensional stability, hardness, stiffness and controlled moisture content .	Stable, but less fit for decking because of the technology that removes substances from the wood cells, making the wood more brittle , resulting in a shorter lifetime versus Kebony.

	KEBONY	VS. WOOD PLASTIC COMPOSITE
Appearance	Authentic wood . Can be left natural, painted or sealed. Naturally develops a silver-grey patina. Versatile material.	Although Wood Plastic Composite tries to mimic the natural beauty of wood, it is not real wood . Achieving a similar appearance is hard.
Durability	Bio-based liquid makes Kebony highly resistant to fungi, rot and other microorganisms . It is not affected by hot or cold weather and does not require anything but occasional cleaning.	Prone to scratches and dents. Wood Plastic Composite is heavier than classic wood but that does not mean it is stronger. Compared to Kebony, composite is significantly weaker and therefore less durable.
Environmental impact	Used liquid is non-toxic, contains no volatile organic compounds and can be disposed of like any other wood. Much lower impact than Wood Plastic Composite in all life stages.	Significant carbon footprint due to its intensive manufacturing process. Furthermore, the material is not easy to recycle or to reuse.



Jones Beach Energy & Nature Center, Wantagh, NY, US

	Chemically modified wood		Untreated softwood	Thermally modified	Tropical hardwood	Wood-Plastic composites	Bamboo composites
	Kebony Clear	Acetylation					
Durability	●●●	●●●	●●	●●	●●●	●●	●●●
Strength	●●●	●●	●●	●●	●●●	●●	●●●
Hardness	●●●	●●	●●	●●	●●●	●●	●●●
Aesthetics	●●●	●●	●●	●●	●●●	●●	●●
Sustainability	●●●	●●	●●●	●●	●●	●●	●●



The Artist's House, Norway, by Atelier Oslo

Award-winning projects

Kebony convinces worldwide

There are numerous award-winning projects with Kebony cladding. When it comes to durability, stability and sustainability, few materials can match our modified natural wood.

Kebony cladding wood is durable and can withstand the harshest climatic conditions. Every wood cladding panel comes with a durability guarantee. You can find the product-related guarantee details on www.kebony.com.

This artist's house in Norway has won an award in the "Housing Exterior" category of the Surface Design Awards 2020 for its striking wooden cladding made of Kebony wood. The award recognises outstanding design and innovative use of materials in international building projects.

The briefing for the architecture studio Atelier Oslo was very precise: two artists wanted a peaceful retreat on a small island on Norway's south coast.

The building was to be bright, contemplative and close to nature. Following these specifications, the architects created an unusual ensemble of wood, glass and concrete that dissolves the boundaries between inside and outside.

Striking wooden cladding

The most striking detail of the artists' house is its wooden façade. The light, wooden framework is both decorative and functional: "The plank structure of the cladding creates a complex play of light and shadow throughout the day, the depth of which gives you the feeling of sitting under a tree," the architects explain.

At the same time, the lattice lets in a lot of light and draws the eye to the area at the back. All the wooden exterior structures, from the small footbridge with stairs at the entrance to the light-flooded flat roof and the ornate frame structure, were built with Kebony Character.

**SURFACE
DESIGN
AWARDS**



Pier 26, New York, by OLIN Studio

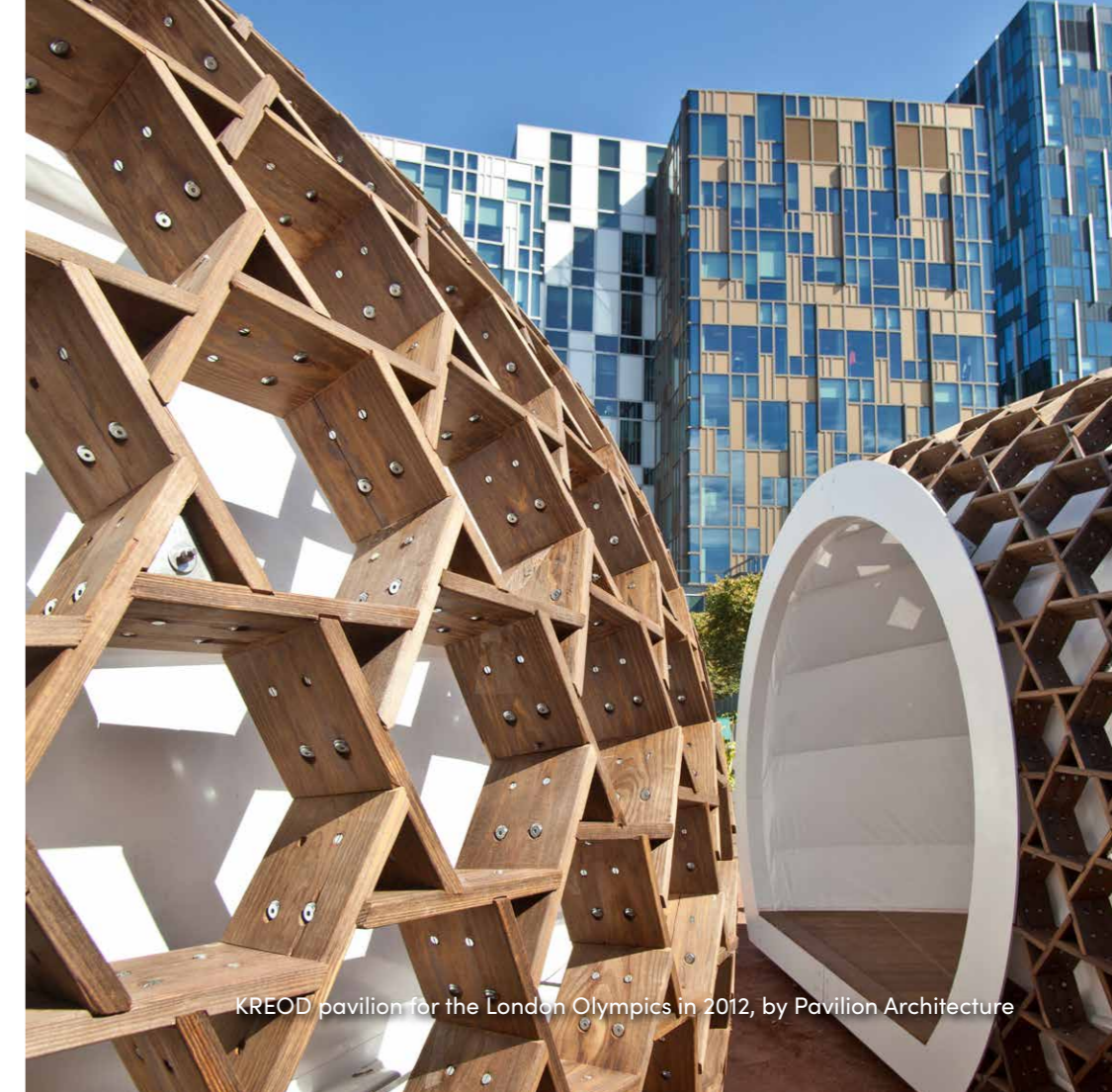

KREOD pavilion for the London Olympics in 2012, by Pavilion Architecture



The Raintree House, Costa Rica, by Bio-Tile Group



Xero studio, Phoenix, by Studio Ma

Customisation

No limits to your creativity

While equal or superior to hardwood in performance and aesthetics, Kebony is easy to work with and customise.

- Versatile and stable wood;
- No harsh additives or glues used in the unique dual modification process;
- Ideal for heavy use in outdoor furniture, urban space design, landscape architecture and creative building design.

Discover the beauty and durability of Kebony for yourself and elevate your next project to new heights.



Oak Hill House, UK, by Claridge Architects

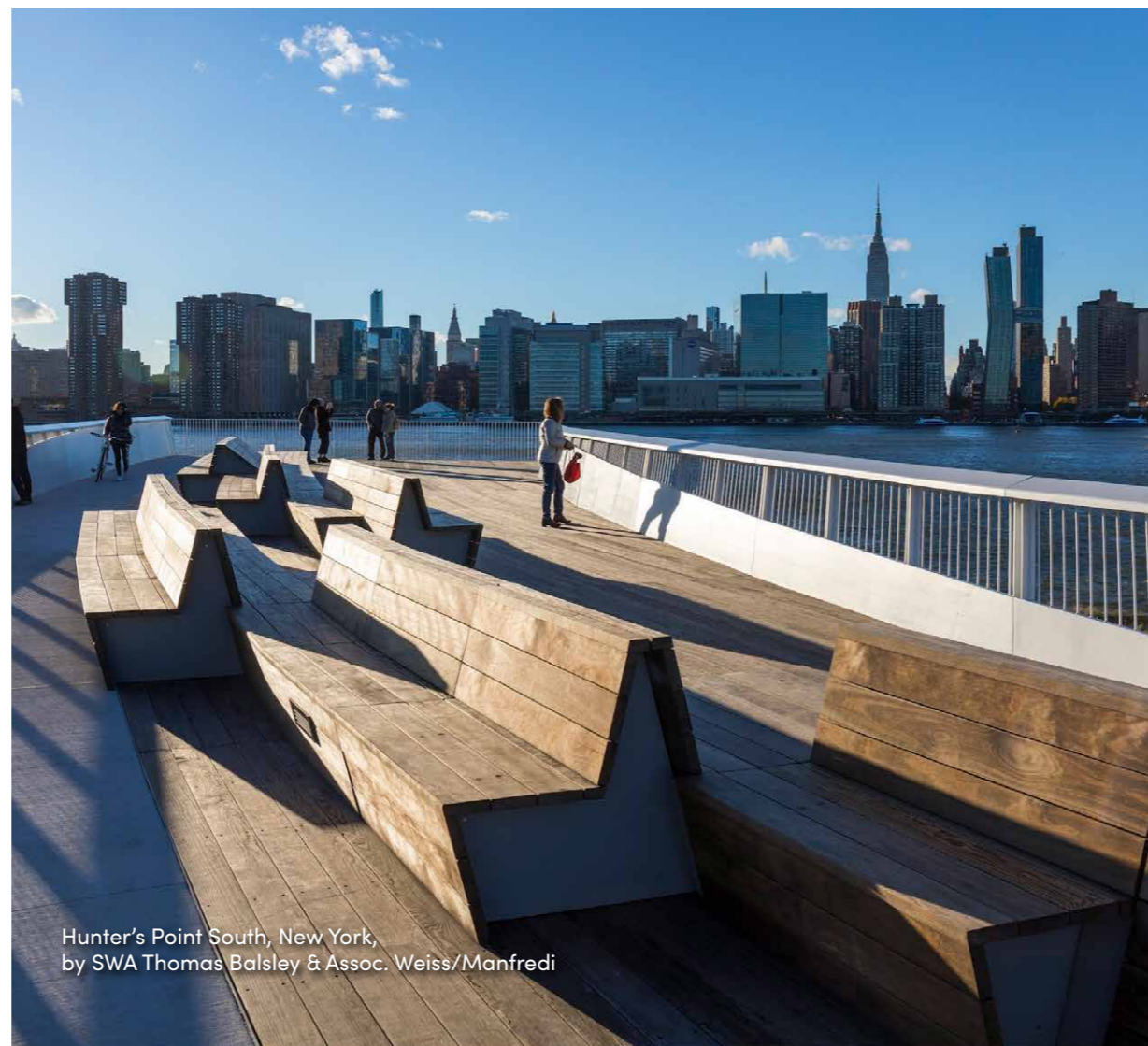

Hunter's Point South, New York,
by SWA Thomas Balsley & Assoc. Weiss/Manfredi



Kebony houses, Norway, by Anne Braatveit

Kebony Decking

Find our full product and accessory range on kebonny.com



Expert insight

Consult the full installation manual before starting your decking project, make sure to use the right sub-construction, to have adequate ventilation as well as the best fastening methods for your desired outcome.

Kebony Character



Art. no. 1127

Decking

Kebony Character 28 x 120 mm



Art. no. 1171

Boardwalk

Kebony Character 34 x 145 mm

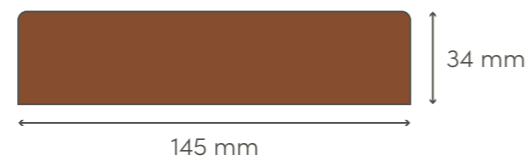

Art. no. 1200

Railing (under-construction)

Kebony Character 48 x 73 mm

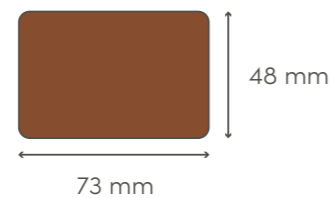

Kebony Clear



Art. no. 2558

Decking

Kebony Clear 22 x 90 mm



Art. no. 2729

Click-In decking

Kebony Clear 22 x 118 mm

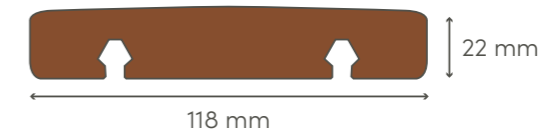

Art. no. 2522

Boardwalk

Kebony Clear 38 x 140 mm



Art. no. 2226

Decking

Kebony Clear 22 x 142 mm

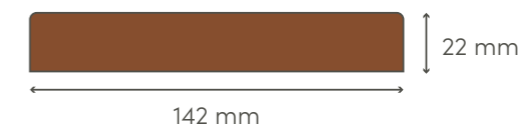

Art. no. 2131

Decking w/side slits

Kebony Clear 22 x 142 mm

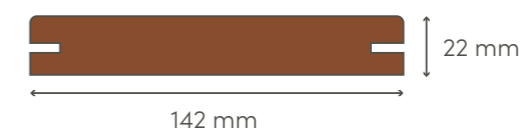

Art. no. 2480

Railing (under-construction)

Kebony Clear 38 x 68 mm

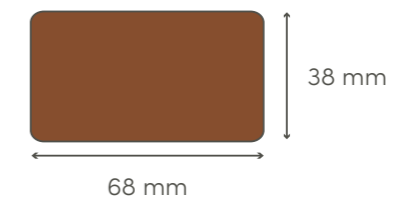

Kebony Cladding

Find our full product and accessory range on kebonny.com



Kebony Character



Art. no. 2216

Shiplap 90°

Kebony Character 21 x 148 mm

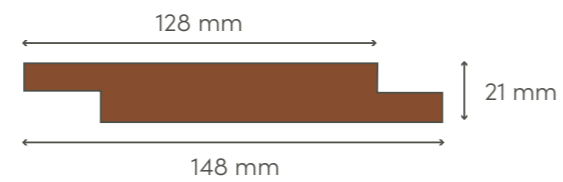

Art. no. 2596

Shiplap 75° shadowline

Kebony Character 21 x 148 mm

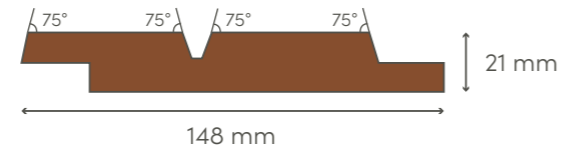

Art. no. 1243

Rectangular

Kebony Character 21 x 148 mm

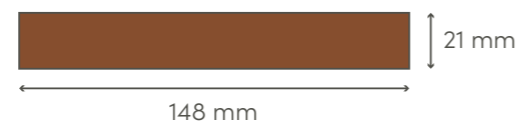

Art. no. 2168

Rhombus 78°

Kebony Character 29 x 59 mm

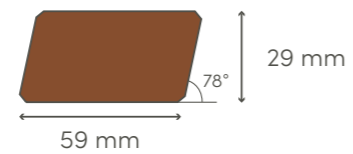

Art. no. 1306

Skewed Slat

Kebony Character 48 x 48/36 mm

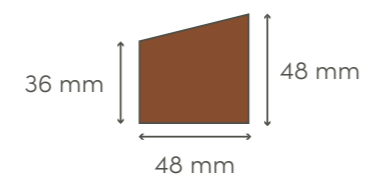

Kebony Clear



Art. no. 2597

Shiplap 75°

Kebony Clear 19 x 120 mm

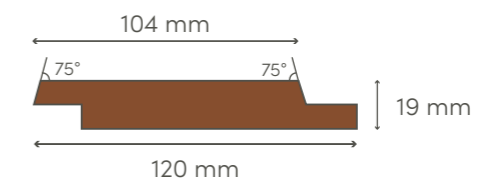

Art. no. 2598

Shiplap 75° shadowline

Kebony Clear 19 x 120 mm

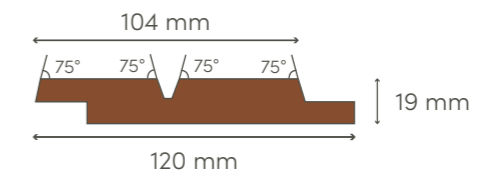

Art. no. 2453

Shiplap 90°

Kebony Clear 19 x 120 mm

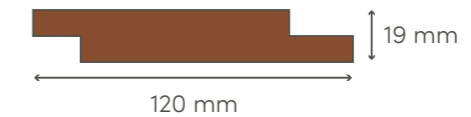

Art. no. 2454

Shiplap 90° shadowline

Kebony Clear 19 x 120 mm

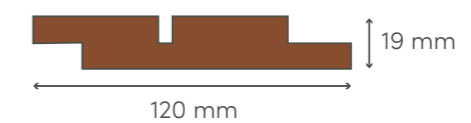

Learn more



Read more on kebonny.com and dive into the advantages Kebony brings to the table for your projects:

[Inspiration](#)

[Product range](#)

[Installation guides](#)

[Latest news](#)

[Contact information](#)

www.kebonny.com



Natural wood Made to last



info@kebonny.com

WWW.KEBONY.COM

